

## End View

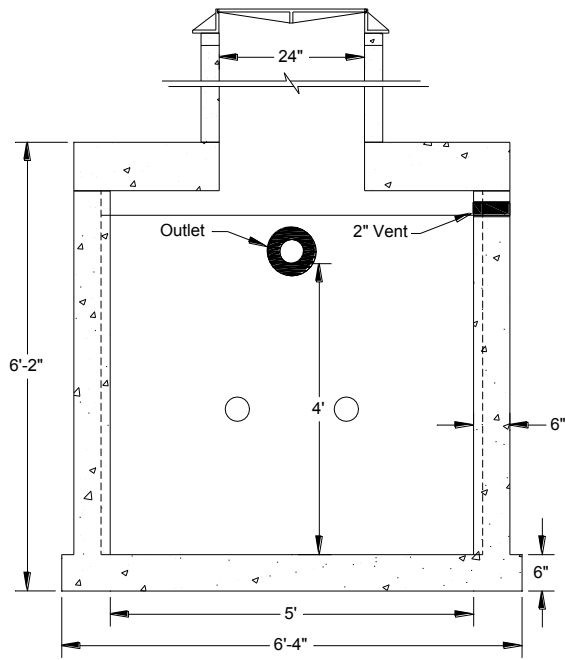

## Cross Section

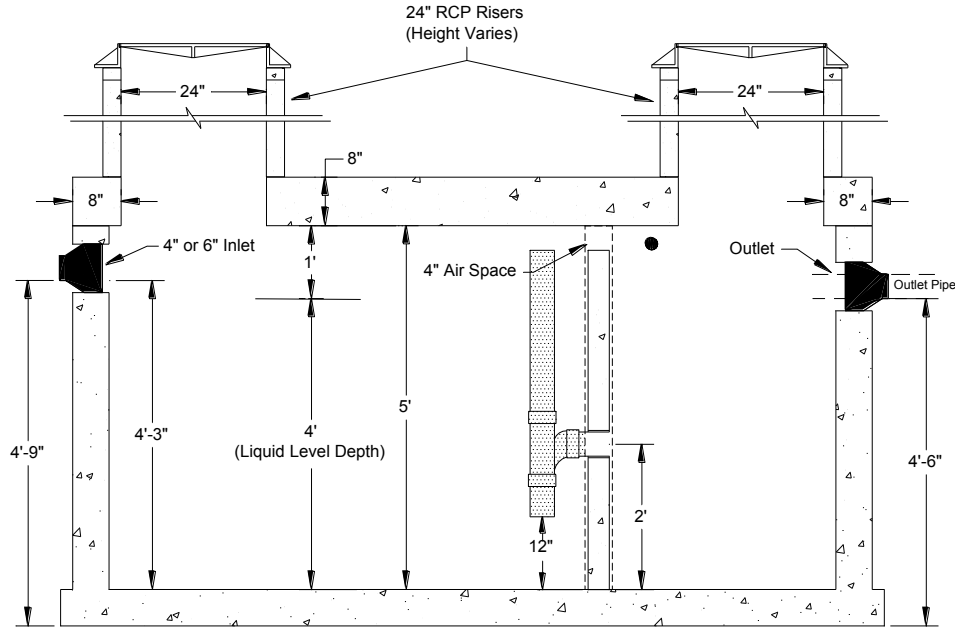

## SPECIFICATIONS

**Tank:** Portland Type V (sulfate resistant) cement, 5000 psi (min), #4 & #5 Grade 60 rebar reinforcement, H-20 traffic rated design, NPC S106-8SWP 4" to 6" flexible rubber boot connectors with all stainless steel hardware for inlet and outlet pipe penetrations, 1 EA slide-in pre-cast baffle wall w/ 2 EA 4" Sch40 PVC couplers, 2 EA 24" dia. access holes in lid.

**Standard Components:** D&L A-1024 cast iron ring and bolt-down cover with gas-tight o'ring gasket "SANITARY SEWER", 2 EA 24" dia. X 2' tall RCP access risers and adjusting rings to bring to final grade, 2 EA 4" Sch40 PVC pipe baffles, Conseal CS-102 butyl mastic to seal down lid and access risers.

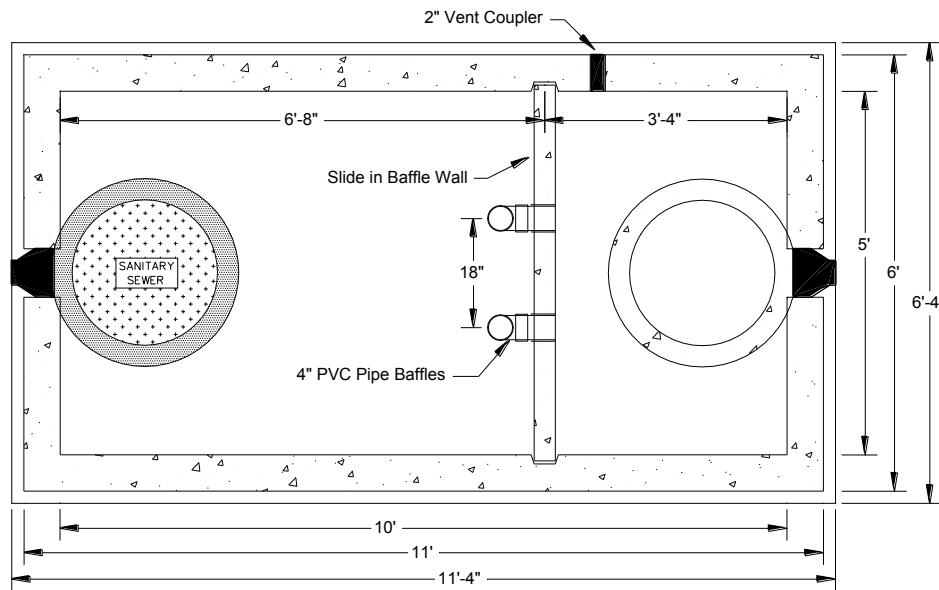

## Top View

**WEIGHTS:** Tank - 17,600 lb.; Lid - 6090 lb; Baffle - 1070 lb. [ Total All Pieces = 27,200 lb. ]

**BILLINGS PRECAST**  
 CONCRETE RESULTS FOR HARD WORKING PEOPLE  
  
 5815 Interstate Avenue, Billings, Montana 59101  
 PH (406) 656-6098 FAX (406) 656-4942  
 www.billingsprecast.com

DWG. NO.

**G115H20**

**1500 Gallon Grease Interceptor**  
 H-20 Traffic Rated Design

SCALE: NONE

DATE: 7-27-12

REV: DRN: WDB