

End View

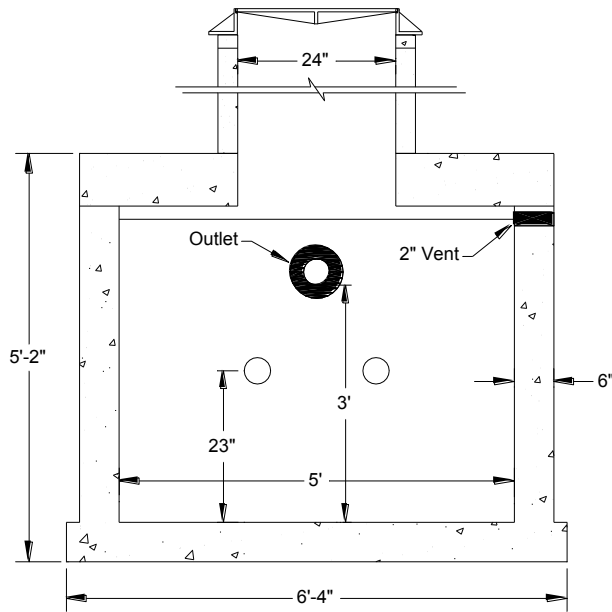

Cross Section

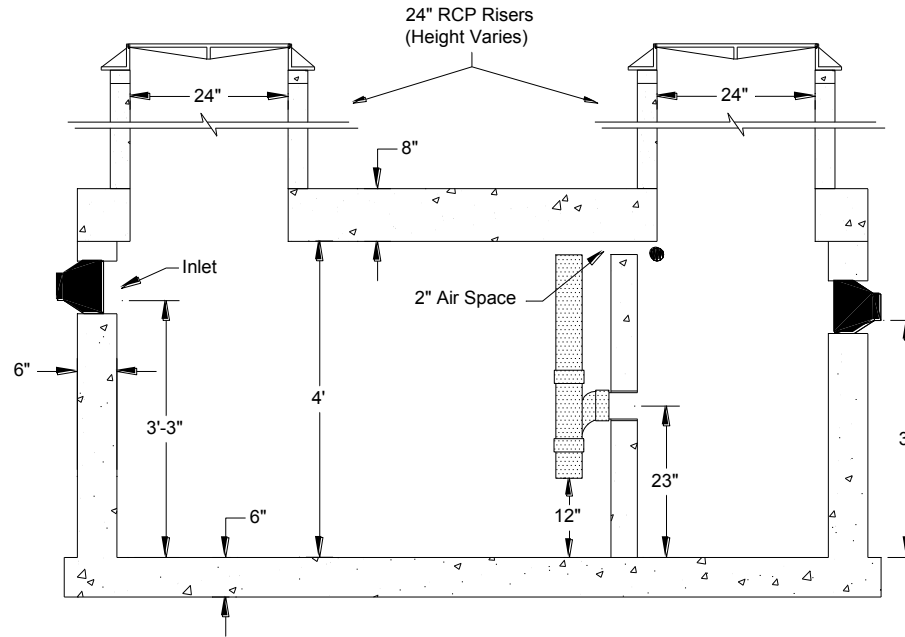

SPECIFICATIONS

Tank: Portland Type V (sulfate resistant) cement, 5000 psi (min), #4 & #5 Grade 60 rebar reinforcement, H-20 traffic rated design, NPC S106-8SWP 4" to 6" flexible rubber boot connectors with all stainless steel hardware for inlet and outlet pipe penetrations, 1 EA slide-in pre-cast baffle wall w/ 2 EA 4" Sch40 PVC couplers, 2 EA 24" dia. Access holes in lid.

Standard Components: D&L A-1024 cast iron ring and bolt-down cover with gas-tight o'ring gasket "SANITARY SEWER", 2 EA 24" dia. X 2' tall RCP access risers and adjusting rings to bring to final grade, 2 EA 4" Sch40 PVC pipe baffles, Conseal CS-102 butyl mastic to seal down lid and access risers.

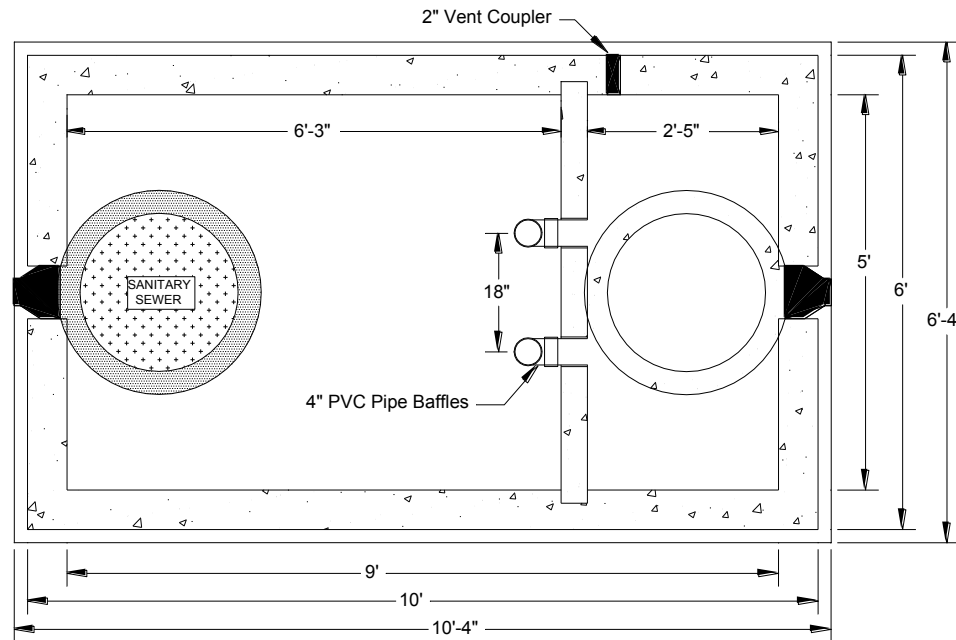

Top View

WEIGHTS: Tank - 14,150 lb.; Lid - 5450 lb; Baffle - 1000 lb. [Total All Pieces = 23,060 lb.]

BILLINGS PRECAST
CONCRETE RESULTS FOR HARD WORKING PEOPLE

5815 Interstate Avenue, Billings, Montana 59101
 PH (406) 656-6098 FAX (406) 656-4942
 www.billingsprecast.com

DWG. NO. **G110H20**

1000 Gallon Grease Interceptor
 H-20 Traffic Rated Design

SCALE: NONE	DATE: 7-27-12	DRN: WDB
REV: A		